

# DS-9104/9108/9116HFI-RH Standalone DVR

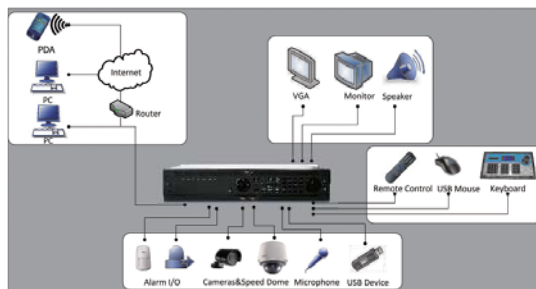

## Key Features

- H.264 Video Compression
- 4CIF Resolution Real-time Recording
- HDMI output at 1920 x 1080 Resolution
- RAID 0, RAID 1, RAID 10 & RAID 5 Support
- Easy HDD Assembly & Replacement



## Specifications

		DS-9004HFI-RH	DS-9008HFI-RH	DS-9016HFI-RH
Video/Audio input	Video compression	H.264		
	Analog video input	4-ch, BNC (1.0 Vp-p, 75 Ω), PAL / NTSC adaptive	8-ch, BNC (1.0 Vp-p, 75 Ω), PAL / NTSC adaptive	16-ch, BNC (1.0 Vp-p, 75 Ω), PAL / NTSC adaptive
	Audio compression	OggVorbis		
	Audio input	4-ch, BNC (2 Vp-p, 1 kΩ)	8-ch, BNC (2 Vp-p, 1 kΩ)	16-ch, BNC (2 Vp-p, 1 kΩ)
	Voice talk input	2-ch, BNC (2 Vp-p, 1 kΩ)	2-ch, BNC (2 Vp-p, 1 kΩ)	2-ch, BNC (2 Vp-p, 1 kΩ)
Video/Audio output	Preview resolution	PAL: 704 × 576, NTSC: 704 × 480		
	HDMI output	1, resolution: 1024 × 768 / 60 Hz, 1280 × 1024 / 60 Hz, 1920 × 1080 / 60 Hz		
	VGA output	1, resolution: 1024 × 768 / 60 Hz, 1024 × 768 / 70 Hz, 1280 × 1024 / 60Hz		
	Encoding resolution	4CIF / DCIF / 2CIF / CIF / QCIF		
	Video output	2-ch, BNC (1.0 Vp-p, 75 Ω)		
	Video loop out	Optional		
	Frame rate	4CIF / DCIF / 2CIF / CIF / QCIF: 25 fps (P) / 30 fps (N)		
	Video bit rate	32 Kbps - 2048 Kbps, or user defined (Max. 6144 Kbps)		
	Audio output	2-ch, BNC (Linear Electrical Level, 600 Ω)		
	Audio bit rate	16 kbps; or 32 bps when the HDMI output is connected		
	Dual stream	Support		
	Stream type	Video / Video & Audio		
Hard disk driver	Interface type	8 SATA interfaces		
	Capacity	Each interface supports more than 2TB capacity		
Disk array	Array type	RAID 0, RAID 1, RAID 10, RAID 5		
	Array number	4		
	Virtual disk	8		
External interface	Network interface	1, RJ45 10M / 100M / 1000M adaptive Ethernet		
	Serial interface	1 RS-232 interface (for parameters configuration, maintenance, transparent channel); 1 RS-485 interface (for PTZ control); 1 RS-485 keyboard interface (for special keyboard control)		
	USB interface	3, USB2.0		
	Alarm in	16		
	Alarm out	4		
General	Power supply	100 - 240 V AC, 6.3 A, 50 - 60 Hz		
	Consumption	≤ 70 W (without hard disk or DVD-R/W)		
	Working temperature	-10°C - +55 °C (14 °F - 131 °F)		
	Working humidity	10% - 90%		
	Chassis	19" standard 2U chassis		
	Dimension	450 (D) × 450 (W) × 95 mm (H) (17.72" (D) × 17.72" (W) × 3.74" (H))		
	Weight (without HDD)	≤ 8000 g (17.64 lbs)		